



MAQUINARIA AGRÍCOLA SEGUÉS S.L.

Avda. Santuari s/n
25215 SANT RAMON
(Lleida)
Tel.: +34 973 52 43 36
Fax: +34 973 52 43 81

www.seguessl.com
segues@seguessl.com
recanvis@seguessl.com
export@seguessl.com
administracio@seguessl.com



CHISEL

FRAME 100X100 & TINE 40X40



WWW.SEGUESSL.COM

www.seguessl.com

SEGUÉS, since 1978 providing quality and performance

For an optimal tilling job over hard, stony, with too much stubble soils, etc... a strong implement, with tine clearance and with a high working depth versatility is required, the new **CHISEL SEGUÉS CH-100**

Benefits

- Versions with two or three tines lines
- 40x40 Tines
- 300 mm distance from tine to tine in two lines versions.
- 730 mm tine height
- 250 mm distance from tine to tine in three lines versions.
- Third point hitch
- New and innovative folding system for a shorter transport width

Punts forts CH-100

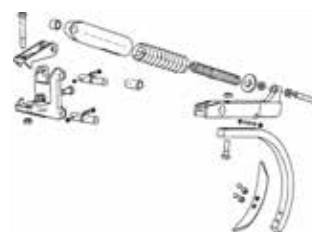

Tine and hitch CH-100



Third point hitch



New vertical folding system



Roller adjustment system



Springs pressure adjustment



Tine hitch system to the frame



Two tines lines



Three tines lines

Standard features in all SEGUÉS CH-100

- Third point Hitch
- Ultra strong double spring system
- 40x40 tine
- Tines made in high quality cast iron
- Two sided shares made of Boron Steel
- Tines pressure adjustment
- Extra strength frame
- Prime and paint high resistant to corrosive agents (water, sun, moisture, fog... etc...)



Tines pressure adjustment



Two sided share made of boron steel



Reinforced frame with structural tubing



Third point hitch

Technical features

Two 40x40 tine lines chisel

| Model | Folding | Tines | Working width | Transport width | Power |
|------------|-----------|-------|---------------|-----------------|------------|
| CH-100-5B | Fixed | 5 | 1.800 mm | 1.800 mm | 70/80 cv |
| CH-100-7B | Fixed | 7 | 2.100 mm | 2.100 mm | 90/100 cv |
| CH-100-9B | Fixed | 9 | 2.700 mm | 2.700 mm | 100/120 cv |
| CH100-11B | Fixed | 11 | 3.300 mm | 2.970 mm | 120/130 cv |
| | Hydraulic | | | | |
| CH-100-13B | Fixed | 13 | 3.900 mm | 2.970 mm | 130/150 cv |
| | Hydraulic | | | | |
| CH-100-15B | Hydraulic | 15 | 4.500 mm | 2.970 mm | 150/170 cv |
| CH-100-17B | Hydraulic | 17 | 5.100 mm | 2.970 mm | 170/190 cv |
| CH-100-19B | Hydraulic | 19 | 5.700 mm | 2.970 mm | +200 cv |

Three 40x40 tine lines chisel

| Model | Folding | Tines | Working width | Transport width | Power |
|-------------|-----------|-------|---------------|-----------------|------------|
| CH100-3F10B | Fixed | 10 | 2.500 mm | 2.500 mm | 100/120 cv |
| CH100-3F13B | Fixed | 13 | 3.250 mm | 2.970 mm | 130/150 cv |
| CH100-3F14B | Hydraulic | 14 | 3.500 mm | 2.970 mm | 140/160 cv |
| CH100-3F16B | Hydraulic | 16 | 4.000 mm | 2.970 mm | 160/180 cv |
| CH100-3F18B | Hydraulic | 18 | 4.500 mm | 2.970 mm | 180/220 cv |
| CH100-3F20B | Hydraulic | 20 | 5.000 mm | 2.970 mm | 200/240 cv |
| CH100-3F22B | Hydraulic | 22 | 5.500 mm | 2.970 mm | 220/260 cv |
| CH100-3F24B | Hydraulic | 24 | 6.000 mm | 2.970 mm | 240/280 cv |
| CH100-3F26B | Hydraulic | 26 | 6.500 mm | 2.970 mm | +280 cv |

Available options for SEGUÉS CHISEL



Roller



Comb made of 10mm springs